

The new eBase® Controller does the trick

The eFlow®*rapid* nebuliser system still stands for efficient, safe and fast inhalation treatment combined with even more advantages!

It's...



...More flexible

Higher mobility thanks to handy controller design and battery pack.



...More individual

Setting options for individual controller light and sound settings.

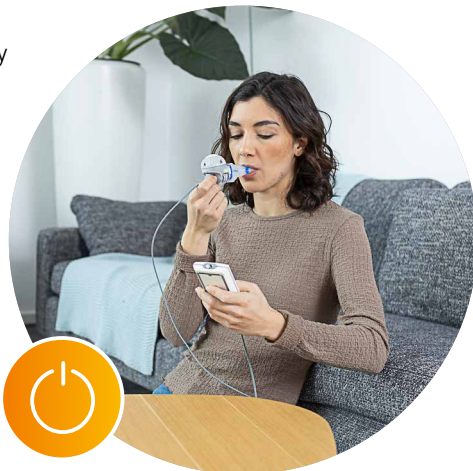

...Time-saving

Thanks to short nebulisation times¹ (eFlow® Technology) and immediate switch-off at the end of inhalation.

Frequently Asked Questions



The most frequently asked questions about the eFlow®*rapid* nebuliser system are answered here.



Product information, incl. handling videos can be found here.

¹ Naehrig S et al. Eur J Med Res 2011; 16(2): 63- 6



PARI Pharma GmbH, Moosstraße 3, 82319 Starnberg, GERMANY, Email: info@pari.de, Tel. +49 (0)8151 279 0, www.pari.com

178D1126-A-2024-02



Flexible
with the new eFlow®*rapid*
nebuliser system



www.pari.com

Newly designed
eBase® Controller
for better handling
and more mobility



Quick Guide

- 1 Please read the entire Instructions for Use (IFU) taking note of all warnings and cautions. Please note that reading this Quick Guide should not replace reading the full IFU.
- 2 Check you have all necessary parts.

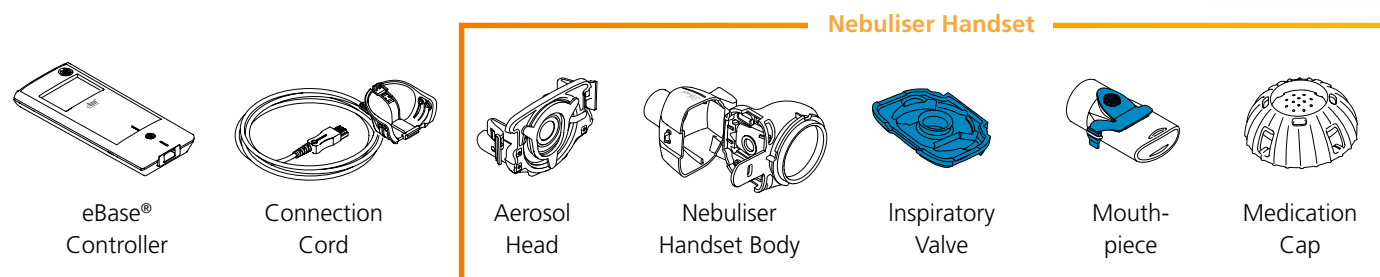

- 3 Clean your nebuliser handset parts before you use them for the first time and immediately after each use.
- 4 Disinfect your nebuliser handset parts after each treatment day.

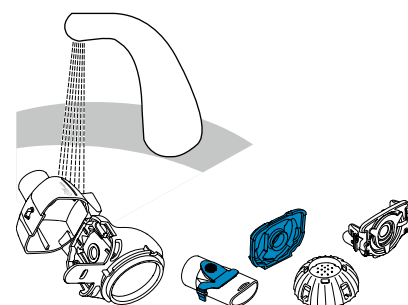

1. Rinse each nebuliser handset part for about 5 seconds.

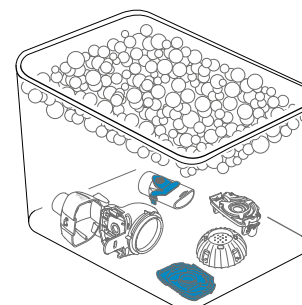

2. Soak parts for 5 minutes in warm soapy water and then rinse thoroughly.

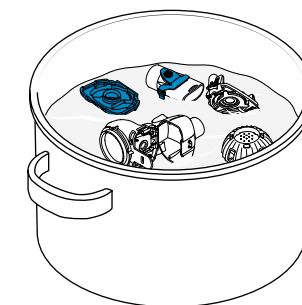

3. Disinfect by boiling for 5 minutes in distilled water or use one of the other methods (see IFU), then air-dry.

- 5 Assemble your nebuliser handset.

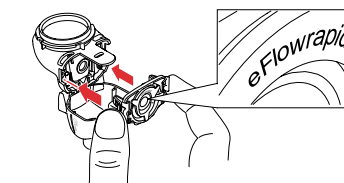

1. Insert the aerosol head and then insert the blue inspiratory Valve.

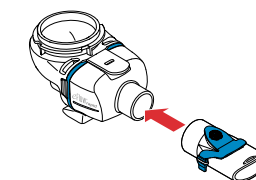

2. Attach the mouthpiece.

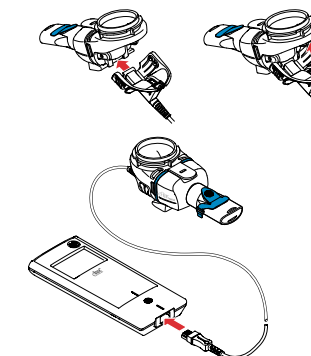

3. Attach the connection cord to the nebuliser handset and to the controller.

- 6 Take your treatment.

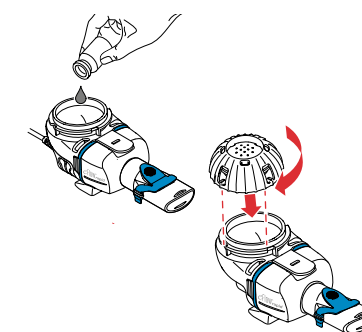

1. Add the drug to the medication reservoir and attach the medication cap.

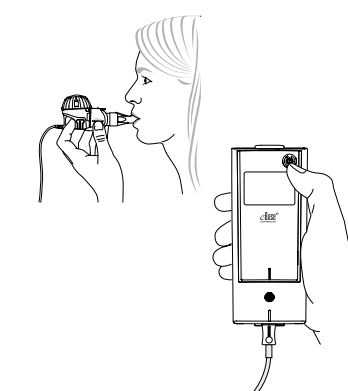

2. Place the nebuliser handset in your mouth and then start the controller.

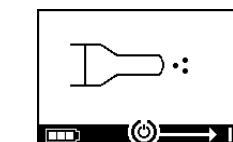

3. The controller screen shows that nebulisation is in progress.